

ALLDAY
& MILLER



Squirrels Close, Uxbridge, UB10 9NZ
£900,000

 4  2  2  C



Squirrels Close, Uxbridge, UB10 9NZ

£900,000

- Four Bedrooms
- Two Reception Rooms
- Garage Perfect For Conversion Into Living Space
- Desirable Cul De Sac Of Sweetcroft Lane
- Ground Floor W.C
- Two Bathrooms
- Beautiful Landscaped Gardens
- En Suite To Master Bedroom
- Recently Improved and Modernised Throughout
- Utility Room

Description

This beautifully presented family home comprises of a welcoming entrance hallway, a spacious sitting room flowing effortlessly into the dining area which opens out to the private rear garden, a generously sized modern kitchen and a utility room. Completing the ground floor with a garage, perfect for extra storage space or future conversion.

To the first floor an impressive master bedroom measuring 19 x 11 with a large en-suite. The accommodation boasts another three well proportionate bedrooms with a family bathroom.

A front driveway benefiting from off road parking. To the rear a private garden with lawn and patio area perfect for outside dining.

Situation

Squirrels Close is situated off Sweetcroft Lane, within easy reach of Court Park, local shops, schools and the London Underground Station with Piccadilly and Metropolitan Lines. There are also bus links to Brunel University, Hillingdon Hospital, Uxbridge College and Uxbridge Town Centre with its multiple shopping facilities, restaurants and bars.



Floor Plans

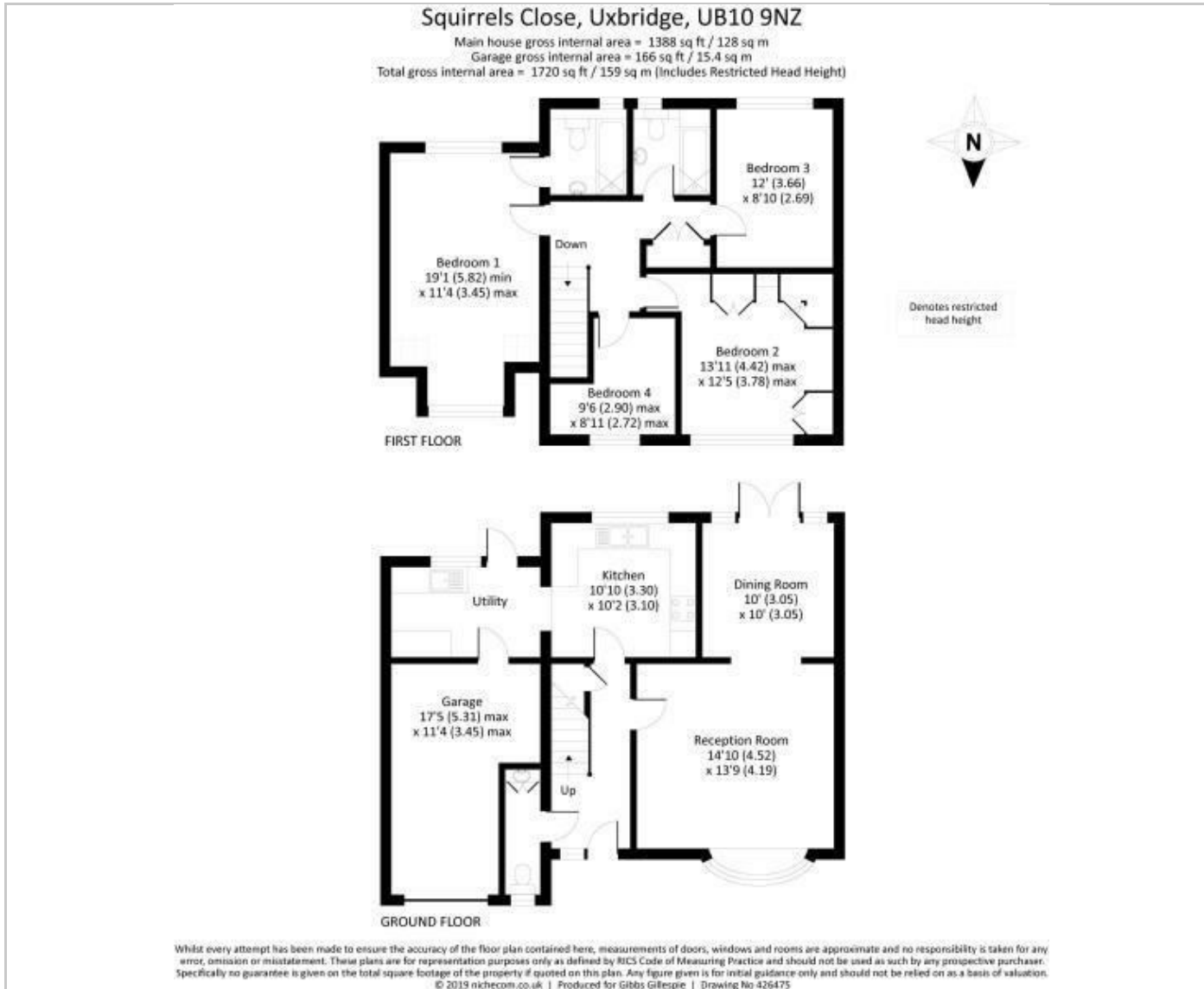

Area Map

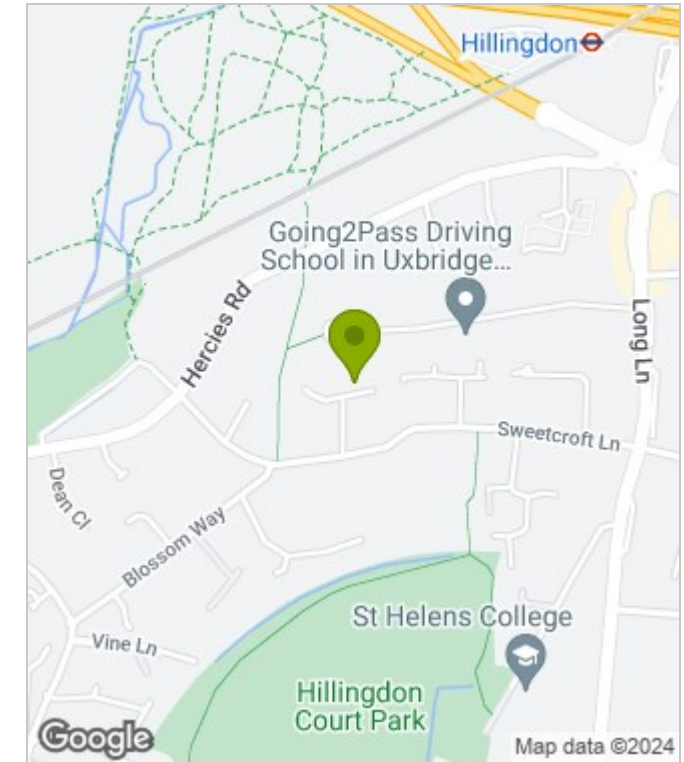

Energy Performance Graph

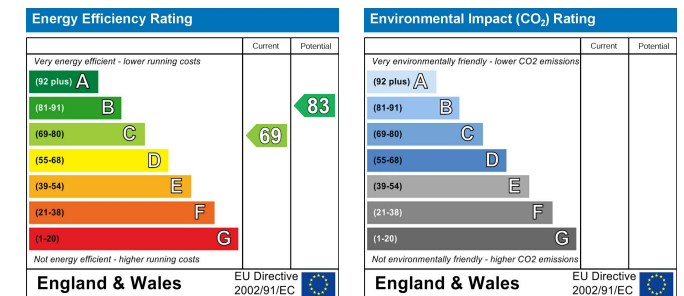

These particulars, whilst believed to be accurate are set out as a general outline only for guidance and do not constitute any part of an offer or contract. Intending purchasers should not rely on them as statements of representation of fact, but must satisfy themselves by inspection or otherwise as to their accuracy. No person in this firm's employment has the authority to make or give any representation or warranty in respect of the property.